

USE VALUE APPRAISAL

FOREST MANAGEMENT PLAN

FOR

[REDACTED]

SPAN: [REDACTED]  
For the 10 years beginning April 1, (2020)

PREPARED BY:

[REDACTED]

I (we) certify that my (our) forest land, exclusive of any house site or other developed portion, is at least 25 acres in size and is under active long-term forest management for the purpose of growing and harvesting repeated forest crops in accordance with minimum acceptable standards for forest management. These management standards include following the practices outlined in the booklet "Acceptable Management Practices for Maintaining Water Quality on Logging Jobs in Vermont" in order to control stream salutation and soil erosion.

By signing below, I (the land owner) understand I am signing my forest management plan and by doing so I agree to manage according to the current approved plan.

Printed Names,

Signatures

Date

X	[REDACTED]	10/7/19
X	[REDACTED]	10/7/19
	[REDACTED]	10/2/19

(Forester)

Approved for Use Value Appraisal by

County Forester

Date

Applicant Name: **Grand List Description:** Address: Applicant Phone: Applicant e-mail:

Town: Granby

Stand No.	Acres	Site Class	Access Distance
<u>1</u>	<u>40</u>	<u>2</u>	<u>&lt; 1 mile</u>

Stand History: Light Thinning in past 10 yrs

Stand Description: EVEN-AGE 2-aged 80 yrs  
 Or UNEVEN-AGE 30 yrs

Forest Type: N. Hardwood

Stocking Level: B-A Line

Quadratic MSD: 9

Total BA: 75 AGS BA: 60

Over-story (10-20" dbh stems):  
 S. Maple - 35% Beech - 20%  
 R. Maple - 15% b. cherry - 5%  
 Y. birch - 15% ash - 5%  
 W. birch - 5% Spruce/Hemlock - 45%  
 Under-story

1-6" dbh stems -  
 Maples, beech, birches (heavy to beech)

Description of Stand Conditions: Good quality 5 maple & Y. birch. Portions of stand are steep. Beech stems spreading; scattered mature Y. birch if Maple ready for harvest.

Stand Cruise Data: Prism Factor/Plot size 20 No. of Points/Plots Sampled 14 Sampling Date(s): Sept. 2019

Long Range Objective: Quality Hard Sawlogs  
 EVEN-AGE Management  
 Present Stand Age: 80  
 Rotation Age: 150  
 Scheduled Treatment  
 (Type and Year):  
 Intermediate Thinning  
2022

Harvest 1) poorest quality beech & other small stems  
 2) scattered mature sawlogs.  
 Maintain B-line stocking  
 Favor S. Maple for Retention

Applicant Name:

Address:

Applicant Phone:  
Applicant e-mail:

Town: <u>Green</u>			Grand List Description:		
Stand No.	Acres	Site Class	Access Distance	Stand Description	
<u>2</u>	<u>48</u>	<u>3</u>	<u>3.4</u>	<u>aged</u>	<u>75 yrs</u>
Stand History:			UNEVEN-AGE	Or	<u>30 yrs</u>
Light thinning in past 10 yrs. Mosty Fir was harvested.			Forest Type:	<u>Mixed</u>	
Forest Health Conditions:			Stocking Level:	<u>B-A Line</u>	
Pockets of declining balsam Fir.			Quadratic MSD	<u>7.5</u>	
			Total BA	<u>115</u>	AGS BA <u>80</u>
			Overstory %	<u>20%</u>	Y. birch - <u>20%</u>
			Spruce - <u>20%</u>		W. birch - <u>15%</u>
			Fir - <u>10%</u>		R. maple - <u>20%</u>
					S. maple - <u>10%</u>
					beech - <u>5%</u>
Invasives: <u>NA</u>			Understory:	Mixed saplings/poles (beech, birches, maples, spruce, fir)	
Description of Stand Conditions:			Pockets of thick (2-5" dbh) spruce-fir		
			Groups of individual declining Fir stems. scattered mature birches & maples ready for harvest.		
Stand Cruise Data: Prism Factor/Plot size			<u>20</u>	No. of Points/Plots Sampled	<u>11</u>
			Sampling Date(s): <u>Sept. 20/19</u>		

USE VALUE APPRAISAL PARCEL DATA ENTRY FORM

new  update  amendment  change of ownership

FP&R COUNTY FORESTER USE ONLY

Parcel ID (for Data Entry) (by state) # \_\_\_\_\_ Year of Entry \_\_\_\_\_  
 Year of Plan \_\_\_\_\_ Year of Last Inspection \_\_\_\_\_

- 1) Landowner Name (last name, first name) \_\_\_\_\_
- 2) Landowner Address (Street, PO Box) \_\_\_\_\_  
 (Town) \_\_\_\_\_ (State) \_\_\_\_\_ (Zip Code) \_\_\_\_\_  
 Phone Number \_\_\_\_\_ Email Address \_\_\_\_\_
- 3) Town That Parcel Is In County 4 Total Forestry Acres in Parcel \_\_\_\_\_ (Grand list acreage, minus active agricultural and open land and exclusions)
- 5) Plan Preparer (last name, first name) \_\_\_\_\_ Previous Owner (last name, first name) \_\_\_\_\_
- 7) SPAN \_\_\_\_\_
- 8) Stand information (this information is for data entry only and does not override what is in actual plan):

Stand #	Acres	Even-aged Uneven-aged (existing)	Predominant Site Class (I, II, III or IV)	Stand Type	Quadratic M.S.D.	Total BA	AGS BA	Management Activities	Treatment Year
1	40	even	II	06	9	75	60	2	2022
2	48	even	III	11	7.5	115	80	2 / groups	2022

<sup>1</sup> Update of an existing plan that includes all new stand descriptive data required every 10 years at minimum.  
<sup>2</sup> Change to an approved existing plan does not change the 10-year cycle of the existing plan. If this form is filed with an amendment, indicate the amended information in the appropriate stand, and write an explanation in section 12. Amendments must be signed by the landowner(s).

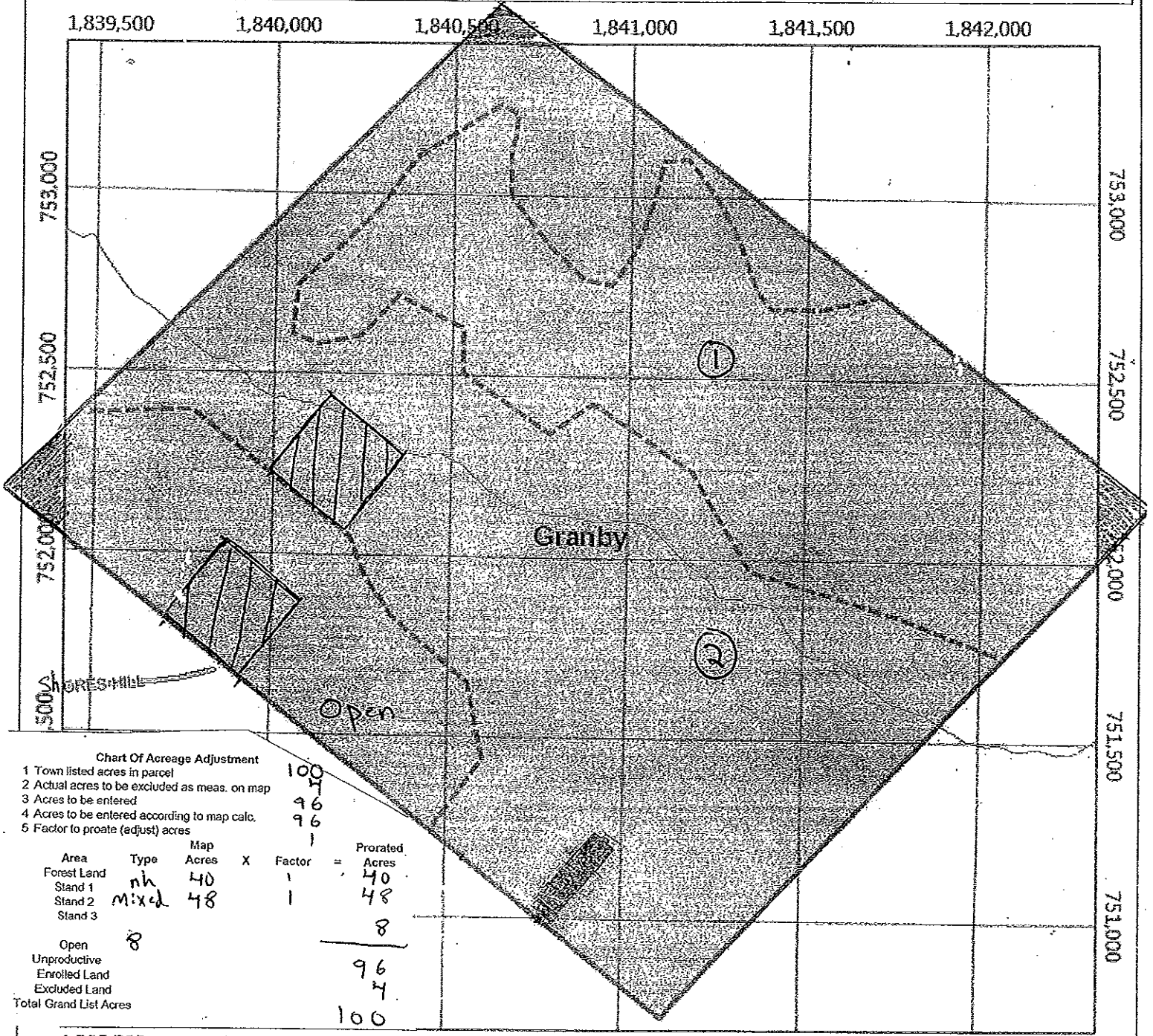

**Chart Of Acreage Adjustment**  
 1 Town listed acres in parcel  
 2 Actual acres to be excluded as meas. on map  
 3 Acres to be entered  
 4 Acres to be entered according to map calc.  
 5 Factor to prorate (adjust) acres

Area	Type	Map Acres	X	Factor	=	Prorated Acres
Forest Land	nh	40				40
Stand 1	Mixed	48		1		48
Stand 2						
Stand 3						
Open		8				8
Unproductive						
Enrolled Land						96
Excluded Land						4
<b>Total Grand List Acres</b>						<b>100</b>

**LEGEND**

Stream ~~~~~

Stand Line - - - - -

Exclusion [Hatched Box]

**NOTES**

SPAN: [REDACTED]

Ortho: [REDACTED]

Drawn by: [REDACTED]

Barnet, VT

1: 5,000

October 2, 2019